



2 Munro Court Bartin Close, Ecclesall, Sheffield, S11 9GF



2 Munro Court Bartin Close Ecclesall

Guide Price

£125,000

GUIDE PRICE £125,000 - £135,000

Situated within the highly sought-after Munro Court development in the heart of Ecclesall, this beautifully presented one-bedroom ground floor apartment offers comfortable, independent living exclusively for the over-60s in a peaceful yet exceptionally convenient location.

Tucked away on a quiet private road just off Ecclesall Road, the development is only a short stroll from an excellent range of local amenities including shops, cafés, the library and regular bus routes providing easy access into Sheffield City Centre.

The apartment itself enjoys a bright and welcoming feel throughout, with a spacious entrance hall leading into a generous living and dining area. Patio doors open directly onto a private outdoor seating area and adjoining communal gardens, creating the perfect spot to relax and enjoy the surroundings. Double doors connect the living space to a modern fitted kitchen, thoughtfully designed with both practicality and style in mind.

The well-proportioned double bedroom benefits from fitted wardrobes, while the contemporary shower room features a large walk-in shower with seating for additional comfort and convenience. A useful hallway storage cupboard provides valuable extra space.

Munro Court is a well-regarded and friendly retirement development offering excellent communal facilities including a residents' lounge with regular social events, communal kitchen, laundry room, beautifully maintained gardens, guest accommodation for visiting family and ample resident parking. For added reassurance, the apartment also benefits from a pull-cord emergency alarm system and on-site management support.

Offered with no onward chain, this delightful home presents an ideal opportunity for those seeking to downsize without compromise, enjoying both privacy and community in one of Sheffield's most desirable suburbs.



- Highly sought-after over 60's development in the heart of Ecclesall
- Spacious one-bedroom ground floor apartment
- Bright and welcoming living/dining room
- Patio doors opening onto a private outdoor seating area
- Modern fitted kitchen
- Generous double bedroom with fitted wardrobes
- Contemporary shower room with walk-in shower and seating
- Excellent communal facilities including lounge, laundry room and guest suite
- Beautifully maintained communal gardens and resident parking
- Quiet private road location close to shops, cafés, library and transport links



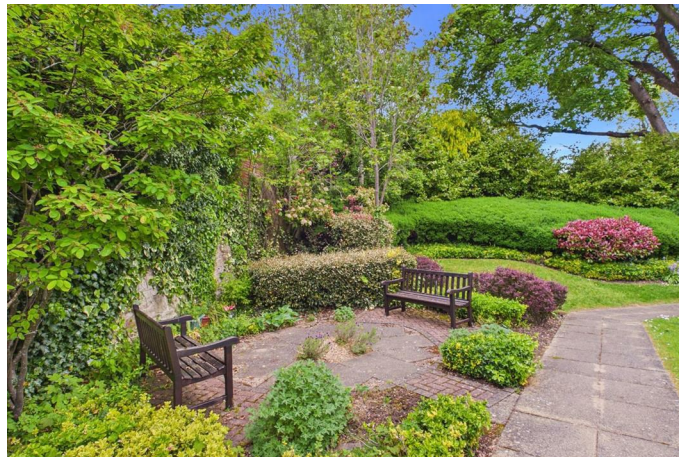

Hallway
3'4" x 6'9"
1.02 x 2.06 m

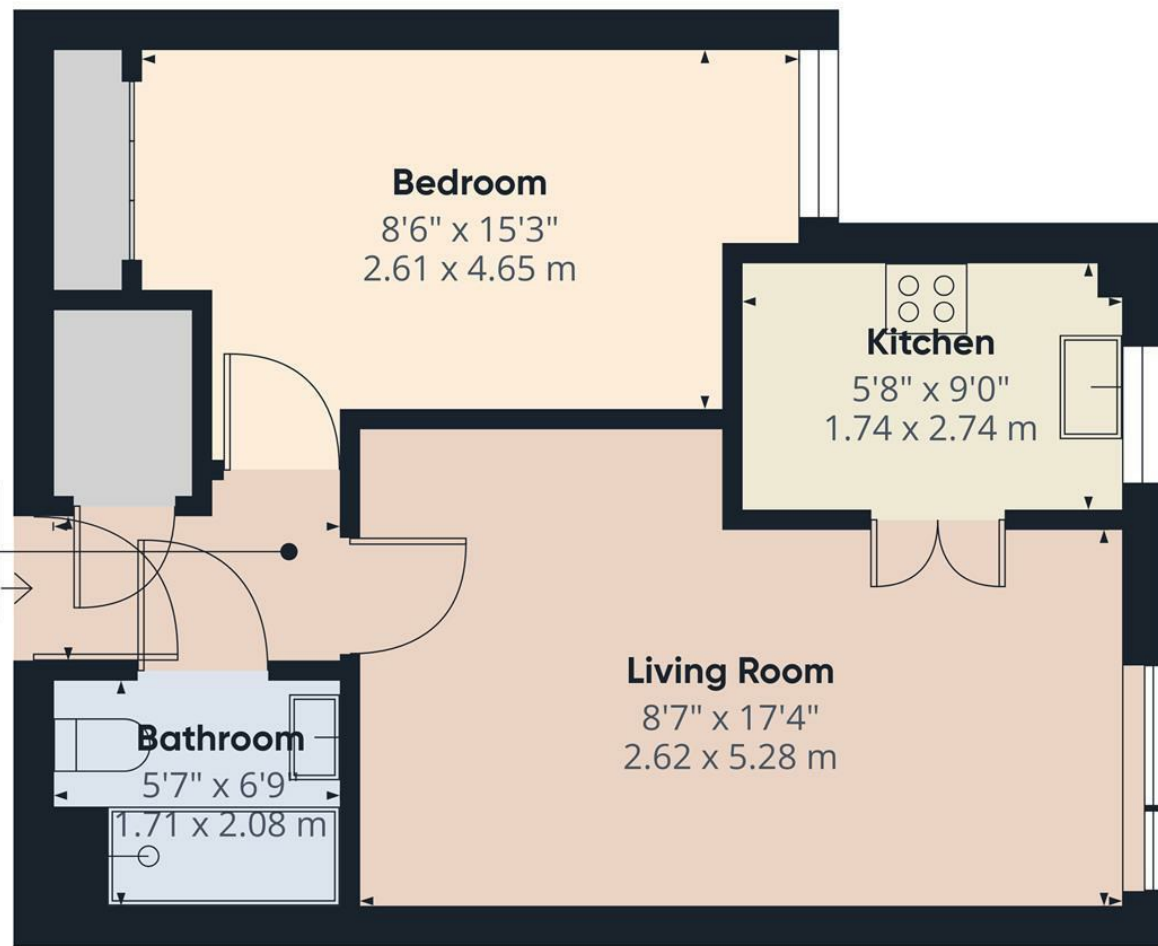

Approximate total area^m
433 ft²
40.2 m²

(1) Excluding balconies and terraces

Calculations reference the RICS IPMS 3C standard. Measurements are approximate and not to scale. This floor plan is intended for illustration only.

GIRAFFE360

While we endeavour to make our sales particulars fair, accurate and reliable, they are only a general guide to the property and, accordingly, if there is any point, which is of particular importance to you, please contact the relevant office. The Agents have not tested any apparatus, equipment, fittings or services and so cannot verify they are in working order. The buyer is advised to obtain verification. Please note all the measurement details are approximate and should not be relied upon as exact. All plans, floor plans and maps are for guidance purposes only and are not to scale. Under no circumstances should they be relied upon as exact or for use in planning carpets and other such fixtures, fittings or furnishings. YOUR HOME IS AT RISK IF YOU DO NOT KEEP UP REPAYMENTS ON A MORTGAGE OR OTHER LOAN SECURED ON IT. 'A Life Assurance policy may be requested.' 'Written Quotations of credit terms available on request.'

Banner Cross
T: 0114 268 3241
E: bannercross@saxtonmee.co.uk
www.saxtonmee.co.uk

Hathersage
T: 01433 650009
E: hathersage@saxtonmee.co.uk

Bakewell
T: 01629 815307
E: bakewell@saxtonmee.co.uk

Matlock
T: 01629 828250
E: matlock@saxtonmee.co.uk